

2050-1000-IP

ODOR CONTROL SYSTEMS



570 MONTROAL RD, RURAL HALL, NC 27045
(336) 969-6909 • 1-800-562-7024 (US) • WWW.WAGERUSA.COM

2050-1000-IP

SPECIFICATIONS

- A.** This specification defines the requirements for a Wager 2050-1000-IP Vent Scrubber 2050FAPC-IWS-1000-IP manufactured by Wager Company in Rural Hall, NC.
- B.** The 2050FAPC-IWS-1000-IP consists of dry-scrubbing media contained in a fabricated aluminum plate housing, powder coated, grass green with a 8" or 10" inlet.
- C.** The 2050FAPC-IWS-1000-IP shall contain 1000 lbs of dry-scrubbing media that is engineered for the removal of H₂S gas. The media is contained in a corrugated plastic container that is 11" x 11" in size.
- D.** The airflow shall be designed for passive applications. The configuration shall be arranged so that the contaminated air shall flow from the bottom flange and be forced upward through the media bed and discharged through ventilated openings.
- E.** The vent check intake contains 316ss, ¼ x ¼ mesh screen, a disc style float, buna seat, 316 guide rod.
- F.** The 2050FAPC-IWS-1000-IP contains EIGHT air admittance valves. They intake directly into the lines without any restrictions from the unit's media bed. This assures continued airflow during pumping sequences needed with air release valves, and with a vacuum sewer system where outside fresh air is required for system operation.
- G.** All components of the 2050FAPC-IWS-1000-IP shall include:
1. A fabricated aluminum plate body, powder coated grass green
 2. 1000 lbs of odor controlling media engineered in pellet form
 3. 8" or 10" flanged connection – Optional metric flange
 4. Tamper proof lockable hook and security latches
 5. Disposable media corrugated plastic insert
- H.** Vent Scrubber Material
1. Fabricated Aluminum plate
 2. Corrugated plastic canister measuring 11 ½" x 11 ½"
 3. Latches in 316SS
 4. Hooks in 316SS
 5. 1000 lbs of odor controlling media for removal of H₂S gas and topped with a layer of POWER-4 Permanganate.
 6. 8" or 10" Flanged Connection with 7.5" (191mm) bolt circle – Optional metric flange
 7. Plastic vent scrubbers that contain activated alumina media or carbon will not be accepted.
 8. Media must be Non-Hazardous before and after it is spent.
- I.** Media Specification
1. Moisture Content: 35% Max
 2. Crush Strength: 35%-70% Max
 3. Abrasion: 4.5% Max
 4. Pellet Diameter: 1/16" – ¼" (1.5mm-6.5mm)
- J.** Wager media only will be accepted due to the high level of capacity. No equals will be accepted. Carbon will not be accepted.
- K.** Only UL certified media will be accepted in Wager's vent scrubber.
- L.** If other media's are used in this unit, it must be designed to be 25% larger with a minimum of 25% additional media.
- M.** The general contractor is responsible for all design cost changes, engineer review time, and testing verification.
- N.** Analytical Services:
1. Samples of the media may be analyzed in order to predict the life of the system media at Wager's expense.



WAGER
C O M P A N Y

www.wagerusa.com
336.9696909
LWager@wagerusa.com
Mpowers@wagerusa.com

2050-1000-IP

REPLACEMENT PARTS LIST

AAU-1000-SET-IP	2050-1000-IP BODY
AAU-1000-LID-IP	2050-1000-IP COVER
VRV-2050	2050 VACUUM RELIEF VALVE
OCU-2050-50	50 LB. CARTRIDGE ODOR CONTROL MEDIA
233-GASKET-3	GASKET, 3.0 "I.D.x 3.5" O.D.
SV- LATCH	UNDER CENTER DRAW LATCH
2500 ACFM	MIST ELIMINATOR PAD
AAU-50-7-G	2050 DOOR GASKET
WS-DRAIN-ASSY	WATER SEPARATOR VALVE
FLT-7.5P-D	7.5" FLOAT POLY DISC
1500-6-G	GASKET 6" 1500 SERIES
1500-6-GR	GUIDE ROD, 6" 1500 SERIES



WAGER
C O M P A N Y

www.wagerusa.com
336.9696909
LWager@wagerusa.com
Mpowers@wagerusa.com

2050-1000-IP

INSTALLATION INSTRUCTIONS

- Pour a concrete pad with bolts in place for slated feet on the unit.
- If preferred, a level crush stone pad may be used in lieu of concrete.
- Set the 1000-IP on pad or stone, and bolt it down.
- Remove media from the unit.
- If the 1000-IP is being used in conjunction with an ARV, get a complete blowout of the ARV so that there is no big slug of air through the media bed.
- Unwrap the media canisters and place in the unit.
- Reinstall the 1000-IP cover, and lock down.



WAGER
C O M P A N Y

www.wagerusa.com
336.9696909
LWager@wagerusa.com
Mpowers@wagerusa.com

2050-1000-IP

INSTALLATION GUIDE



1. Remove media canisters. Ensure all of the original plastic wrap is removed from canisters. Media is in pellet form and should move freely to allow air to vent through. Check media pellets to ensure they are NOT wet.

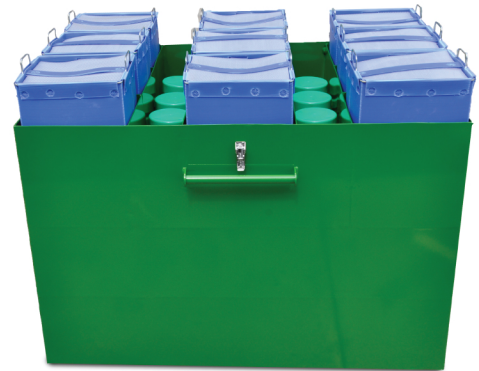

2. Reinstall media canisters ensuring they are flush with the valve's inner chamber.



3. Place unit in desire location. Bolt flange to vent stack.



4. Secure the lid with the four lockable latches



WAGER
C O M P A N Y

*** 2050-450 PICTURED. MODEL 2050-1000-IP FOLLOWS THE SAME STEPS.**

www.wagerusa.com
336.9696909
LWager@wagerusa.com
Mpowers@wagerusa.com

2050-1000-IP

TEST PROCEDURES



(Example of Side flange procedure.)



(Example of bottom flange procedure.)

1. Place Odor Logger in the bottom chamber of the unit, below the media baskets.

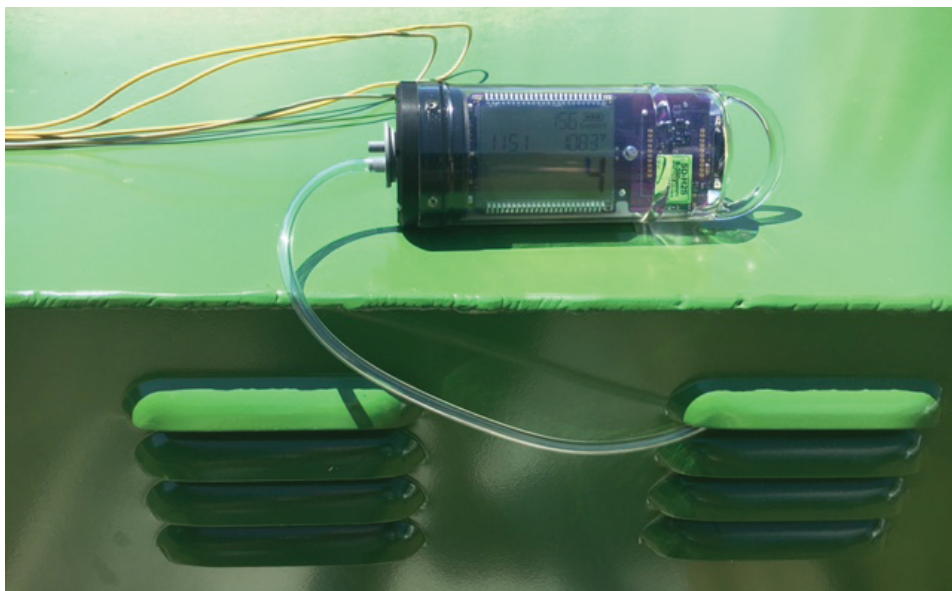

2. Place Odor Logger on top of media baskets, or place tube through the vent louvers.



WAGER
C O M P A N Y

www.wagerusa.com
336.9696909
LWager@wagerusa.com
Mpowers@wagerusa.com

2050-1000-IP

MAINTENANCE GUIDE



1. Unlatch and remove lid from unit. Visually inspect the media canisters and air intake valves.



2. Inspect the media. Make sure it is dry. Shake or stir media pellets inside canisters every 3-6 months for maximum media life.



3. Unbolt water separator access plates. Inspect bolts, washers, and gasket. Remove water separator pads.



4. Wash water separator pad with hose.

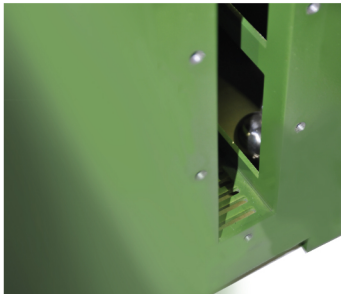

5. With the water separator pad out, inspect float drain assembly. Remove any debris and ensure drain is clean.



6. Reinstall water separator pads, gaskets, and water separator pad plates back onto the unit. Secure the lid with the four lockable latches

2050-450 PICTURED. MODEL 2050-1000-IP FOLLOW THE SAME STEPS.

2050-1000-IP

MEDIA INDICATOR STICKERS

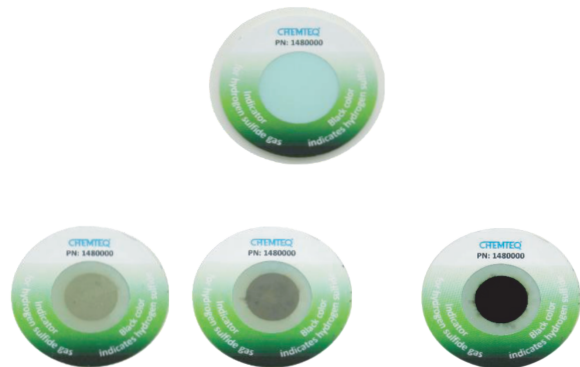

Replace Filter

Over Exposed

Operating Instructions

- Ensure that packaging pouch is intact.
- Open packaging pouch by tearing off the top part from one of side notches
- Remove indicator sticker from the packaging pouch.
- Peel off the protective liner to expose the bottom adhesive (Figure 1).
- Hold the sticker from the edges, as shown in Figure 2, and place it on center clean area of the filter's outlet with the reading area (glossy surface) of the sticker facing up.
- Press firmly to attach sticker to the filter's outlet (Figure 3).
- Replace filter when the reading area of the indicator changes color to brown or black.

*Caution: Do not touch bottom adhesive or the exposure area.

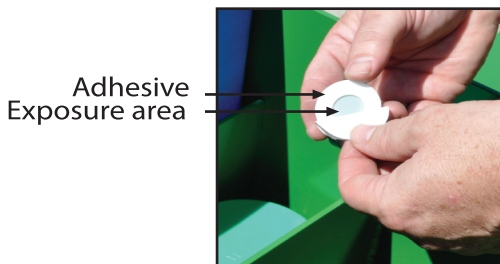

Figure 1



Figure 2

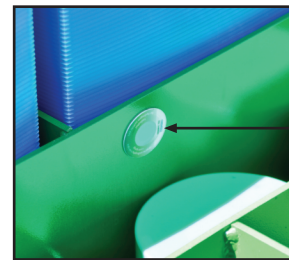

Figure 3



WAGER
C O M P A N Y

www.wagerusa.com
336.9696909
Wager@wagerusa.com
Mpowers@wagerusa.com

WAGER SLATES

WARRANTY ACTIVATION GUIDE

TO ACTIVATE YOUR WARRANTY

- Download the APP on your smartphone or tablet (ios or android) SLATE PAGES
(The Slate Pages LLC)
- Open the APP.
- Create your profile.
- Scan the QR Code on the Wager unit.

UNDER ACTIVATE WARRANTY:

- Tap Activation Date and enter it.
- Tap Contact information and enter it.
- Tap Installation Instructions and review.
- Capture GPS location.
- Capture installation photo (optional)..
- Tap Save (Upper Right Corner).



WAGER
C O M P A N Y

www.wagerusa.com
336.9696909
LWager@wagerusa.com
Mpowers@wagerusa.com