

3000 MANHOLE

ODOR CONTROL SYSTEMS



570 MONTROAL RD, RURAL HALL, NC 27045
(336) 969-6909 • 1-800-562-7024 (US) • WWW.WAGERUSA.COM

3000 MANHOLE

SPECIFICATIONS

A. This specification defines the requirements for a Wager 3000 Vent Scrubber manufactured by Wager Company in Rural Hall, NC. (Compliance with Build America, Buy America Act)

B. The 3000 consists of dry-scrubbing media contained in a fabricated 316SS.

C. The 3000 unit shall contain 50 lbs of dry-scrubbing media that is engineered for the removal of H₂S gas. The media is contained in a corrugated plastic container that is 11" x 18" in size.

D. The airflow shall be designed for passive applications. The configuration shall be arranged so that the contaminated air shall flow from the bottom flange and be forced upward through the media bed and discharged through ventilated openings.

E. All components of the 3000 shall include:

- 1 A fabricated 316ss plate body
- 2 50 lbs of odor controlling media engineered in pellet form
- 3 2" duckbill drain
- 4 Buna gasket top seal, with metal core
- 5 Disposable media corrugated plastic insert
- 6 316ss handles

F. Vent Scrubber Material

1. Fabricated 316ss
2. Corrugated plastic canister measuring 11 1/2" x 18 "
3. 12" square 3/4 x 3/4 ventilation holes, for a 1-1 ratio of venting.
4. 50 lbs of odor controlling media designed for removal of H₂S gas. Plastic vent scrubbers that contain activated alumina media or carbon will not be accepted.

A. Media must be Non-Hazardous before and after it is spent. Media Specification

Moisture Content: 35% Max

B. Crush Strength: 35%-70% Max

C. Abrasion: 4.5% Max

D. Pellet Diameter: 1/16" – 1/4" (1.5mm-6.5mm)

Wager media only will be accepted due to the high level of capacity. No equals will be accepted. Carbon will not be accepted. Only UL certified media will be accepted in Wager's vent scrubber. If other media's are used in this unit, it must be designed to be 25% larger with a minimum of 25% additional media.

The general contractor is responsible for all design cost changes, engineer review time, and testing verification.

Analytical Services:

- E. Samples of the media may be analyzed in order to predict the life of the system media at Wager's expense.



WAGER
C O M P A N Y

www.wagerusa.com

336.9696909

LWager@wagerusa.com

Mpowers@wagerusa.com

3000 MANHOLE

ODOR CONTROL SYSTEMS

PARTS LIST

OCI-2050-50	50 LB. CARTRIDGE ODOR CONTROL MEDIA
OCI-2050-G	OCI GASKET
TG22P	TRAP GUARD 2"



WAGER
C O M P A N Y

www.wagerusa.com
336.9696909
LWager@wagerusa.com
Mpowers@wagerusa.com

3000 MANHOLE

INSTALLATION GUIDE



1. Put a bead of silicone on the interior ring of manhole cover frame.



3. Put a bead of silicone around the top flange of the manhole scrubber. Ensure a positive seal to force all gases through the media canister chamber.

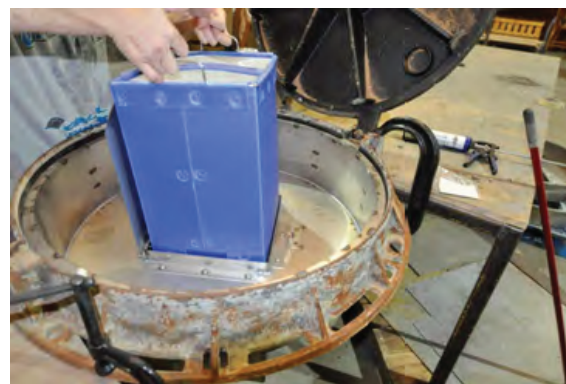

5. Insert media canister (PART # OCI-2050-50) by the handles into the media canister chamber. Push down the canister by its handles until completely in. Close hatch door ensuring it is completely closed before installing manhole lid.

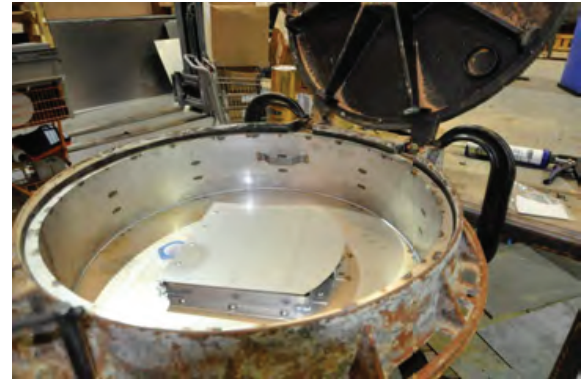

2. Lift empty manhole scrubber by the provided handles, and lower the unit into the manhole opening.

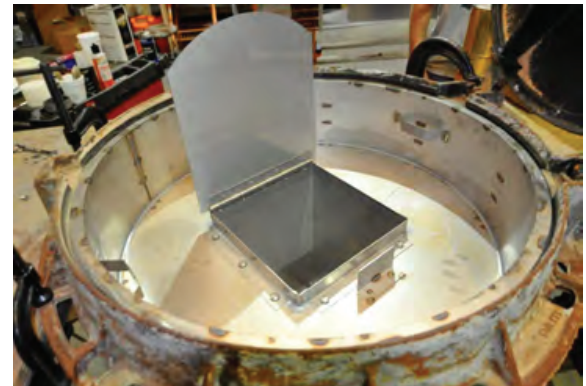

4. Open manhole scrubber hatch door .

MAINTENANCE GUIDE:

- Periodically check that there is no noticeable odors emitting from the unit. Pull out media canister and inspect media inside to ensure that it is dry.
- After any flood event, inspect duck bill drain for and debris.



WAGER
C O M P A N Y

www.wagerusa.com
336.9696909
LWager@wagerusa.com
Mpowers@wagerusa.com

3000 MANHOLE

MEDIA INDICATOR STICKERS



Replace Filter

Over Exposed

Operating Instructions

- Ensure that packaging pouch is intact.
- Open packaging pouch by tearing off the top part from one of side notches
- Remove indicator sticker from the packaging pouch.
- Peel off the protective liner to expose the bottom adhesive (Figure 1).
- Hold the sticker from the edges, as shown in Figure 2, and place it on center clean area of the filter's outlet with the reading area (glossy surface) of the sticker facing up.
- Press firmly to attach sticker to the filter's outlet (Figure 3).
- Replace filter when the reading area of the indicator changes color to brown or black.

***Caution: Do not touch bottom adhesive or the exposure area.**

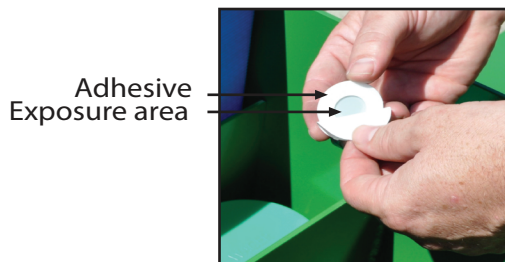

Figure 1



Figure 2

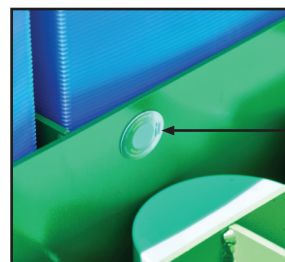

Figure 3



WAGER
C O M P A N Y

www.wagerusa.com
336.9696909
LWager@wagerusa.com
Mpowers@wagerusa.com

WAGER SLATES

WARRANTY ACTIVATION GUIDE

TO ACTIVATE YOUR WARRANTY

- Download the APP on your smartphone or tablet (ios or android) SLATE PAGES
(The Slate Pages LLC)
- Open the APP.
- Create your profile.
- Scan the QR Code on the Wager unit.

UNDER ACTIVATE WARRANTY:

- Tap Activation Date and enter it.
- Tap Contact information and enter it.
- Tap Installation Instructions and review.
- Capture GPS location.
- Capture installation photo (optional)..
- Tap Save (Upper Right Corner).



WAGER
C O M P A N Y

www.wagerusa.com
336.9696909
LWager@wagerusa.com
Mpowers@wagerusa.com